



GoBoard

GoBoard Education Hub & Teacher Console Software Installation Guide

Contents

Introduction.....	2
Installing GoBoard for teachers	4
GoBoard setup wizard	8
GoBoard Education software consists of 3 elements:.....	9
How to install: 3 Options	10
Hub only configuration.....	12
Installing Teacher Console only configuration.....	16
Installing Combined Hub/Teacher Console configuration.....	24
GoBoard Student Apps	29
Software distribution - Export	30
Requirements.....	37
GoBoard Preferred network ports used for Wireless communication.....	38
Where To Get Help	39

Introduction

Thank you for choosing GoBoard Software. This guide will give you all the information to get started.

NOTE: Drive cloning should not be used as the licensing system will not work. If you clone your drive, you will need to insert a new licence.

GoBoard Configuration

GoBoard software is designed to allow display and collaborative whiteboarding between multiple users/devices on the same network. Typically, there is a “Host PC” set up as the HUB, and a second “Console PC” set up to manage the HUB/whiteboard sessions. Other devices can then attach to the whiteboard sessions using free contributor apps* for Windows PCs, Android-based Chromebooks, and iOS devices.

1. * Note: GoBoard contributor apps are available from
 - o Windows 10 – Epson.com (North America), Epson.eu (Epson Europe)
 - o iOS – Apple App store
 - o Android Chromebook/Android – Google App store

The GoBoard software application file contains both the HUB and Console components. In a typical set up, the HUB computer is connected to a projector or other display device. Ideally, the HUB and console are installed on separate computers, allowing greater mobility, as the console computer can then be moved freely about the room. See illustration below:

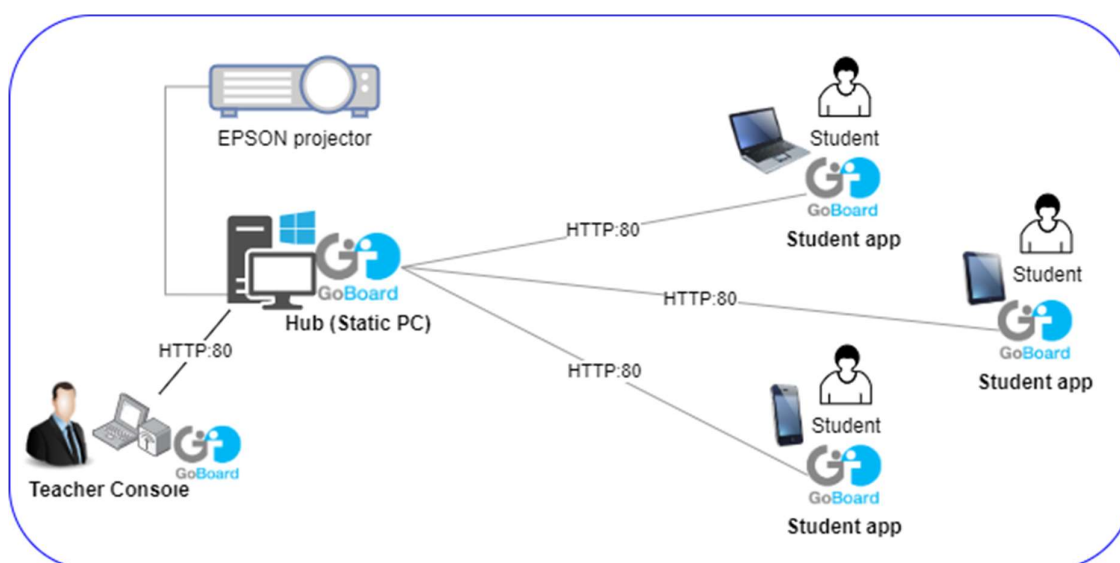

However, it is possible to install both the HUB and Console on a single computer that would both host and manage whiteboard sessions. See illustration below:

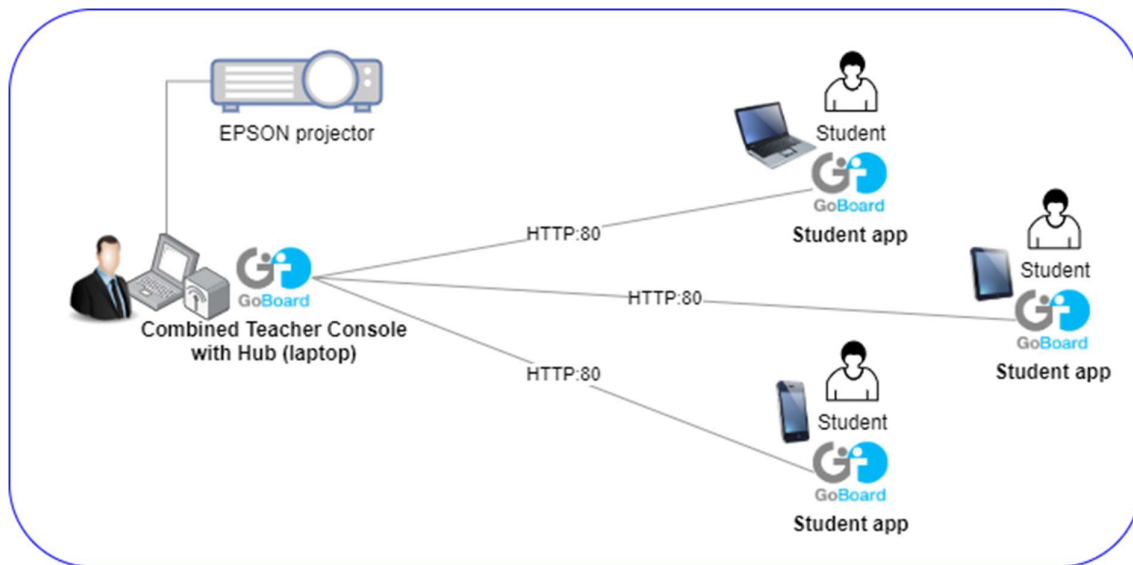

Prior to installing the software, make sure that your device meets the following requirements:

Windows 10 Hub/ Windows 10 Teacher Console

Minimum Requirements

Windows 10 version 1803

- CPU quad-core 2 GHz
- RAM DDR3 8 GB
- Cam and microphone (for AV conferences)

Optimal Specs

- Dedicated graphics card (recommended)
- Stylus for Teacher Console PC

If you have not already downloaded the GoBoard software, you can download it from the Epson website.

In the USA go to www.epson.com

In Canada go to www.epson.ca

In Europe go to www.epson.eu

Download the application and save it to your Windows preferred directory: ([HERE LINK](#))

Once downloaded, double-click the setup .exe: ([SETUP.exe](#)) and follow the on-screen instructions to install GoBoard on Windows.

Installing GoBoard for teachers

After you have read through the terms and conditions, you must accept the End User Licence Agreement to continue. To do this select “I accept the agreement” option and then click on “Next”.

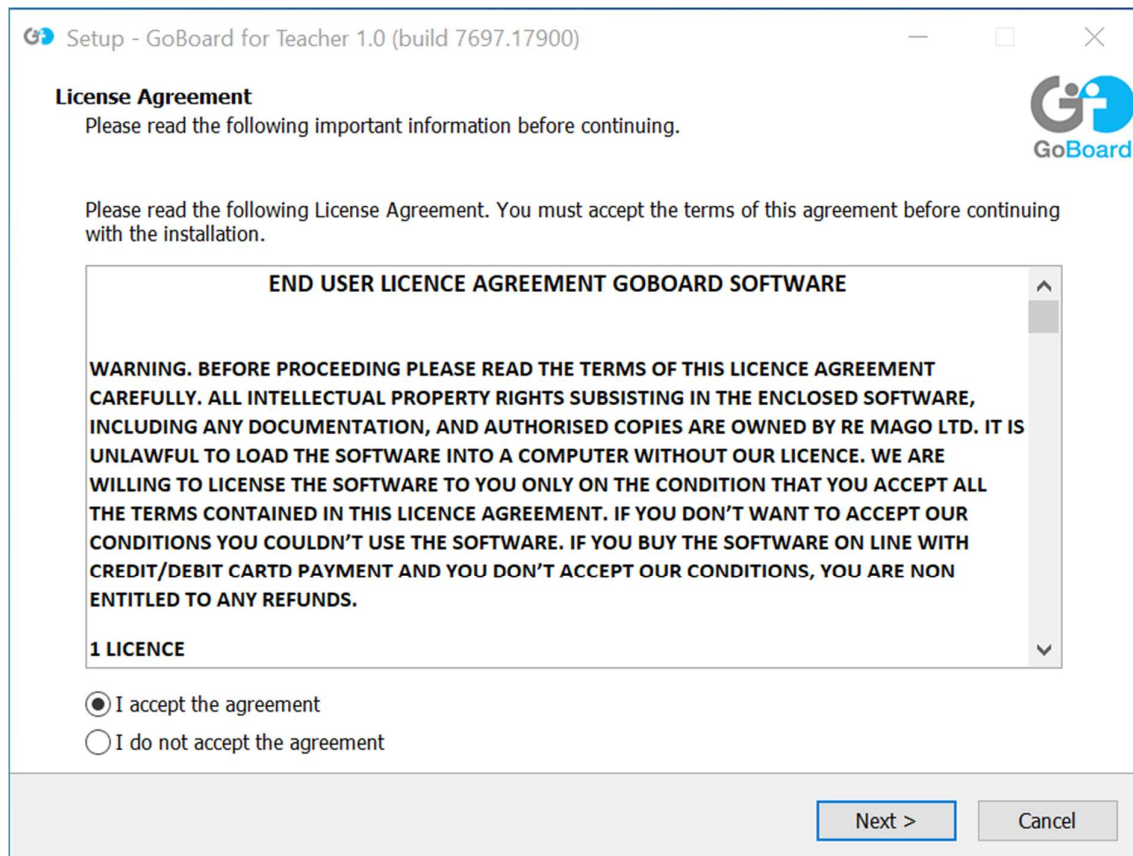

Choose where to install the GoBoard application. The default path is C:\Program Files\GoBoard, but you may choose a different folder if preferred. Once decided, click on “Next”.

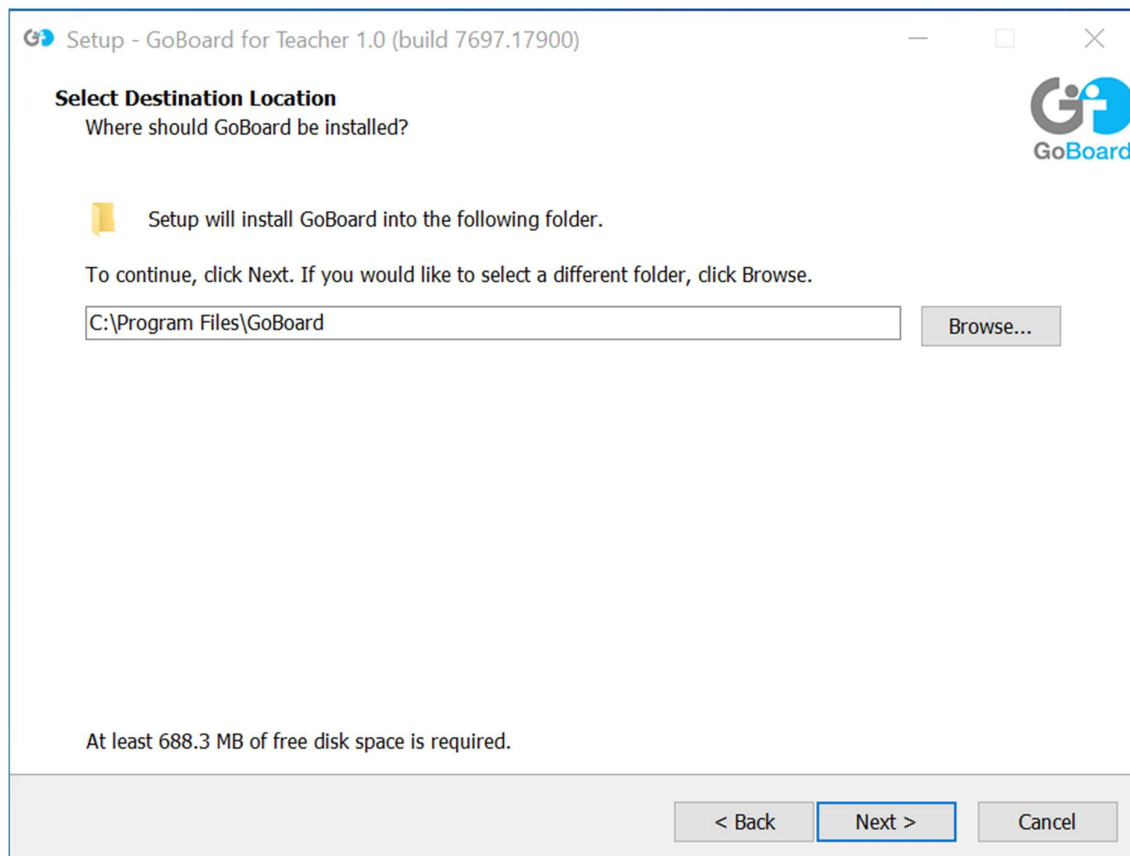

Click on "Next" to continue the GoBoard installation.

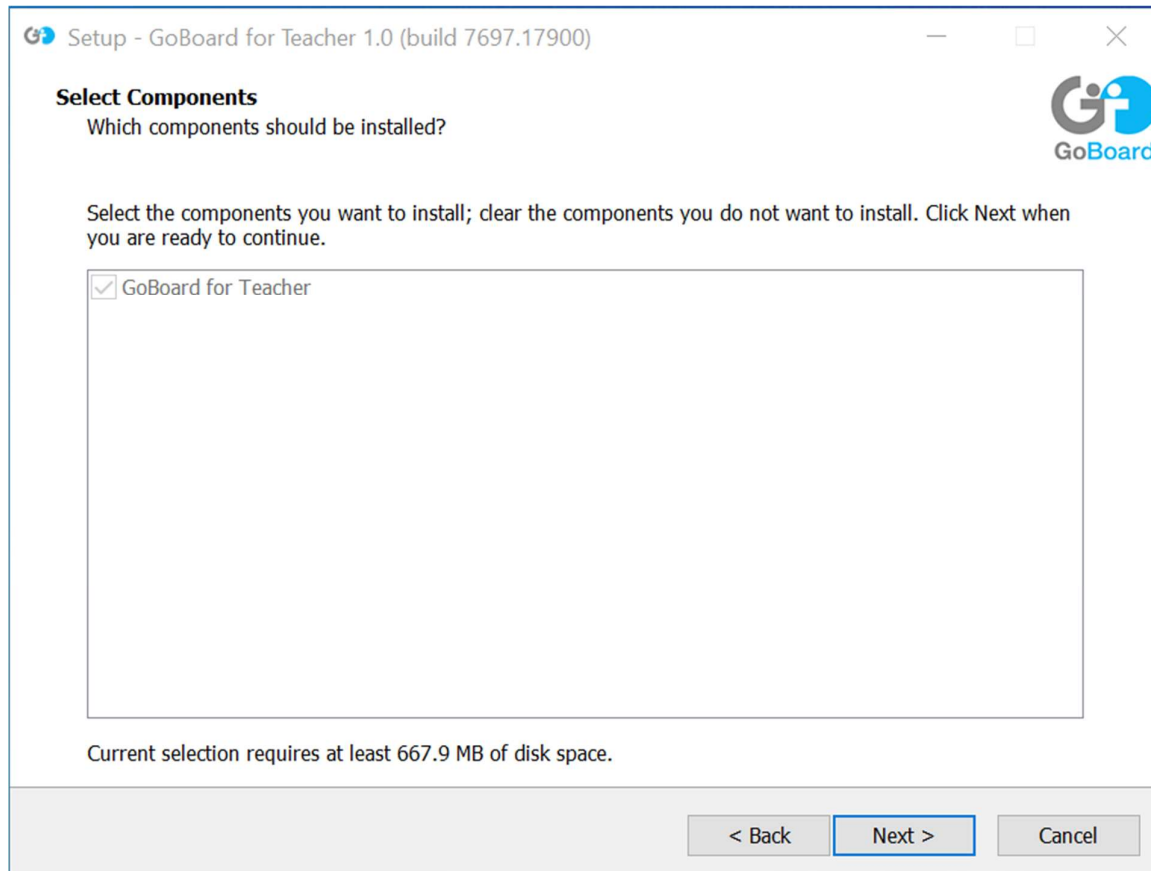

Click on “Install” and wait for the installation process to finish.

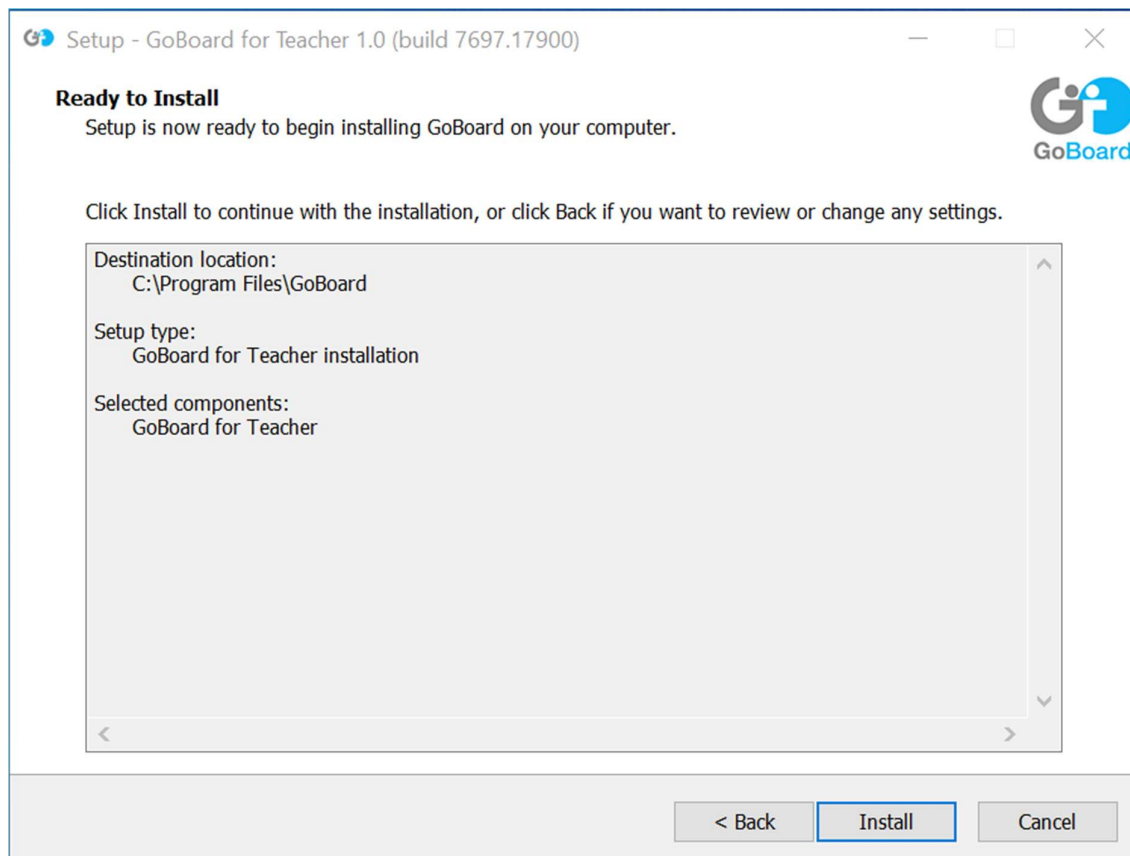

Once installation is completed, a pop-up screen will appear.

If you wish to have the GoBoard software open automatically, select the Launch GoBoard box when installation ends.

Click on “Finish” to end the installation process.

NOTE: When you create apps and then open them, from GoBoard, the apps must open in front of the whiteboard. If apps open behind the whiteboard, a **reboot** of the PC is **recommended**.

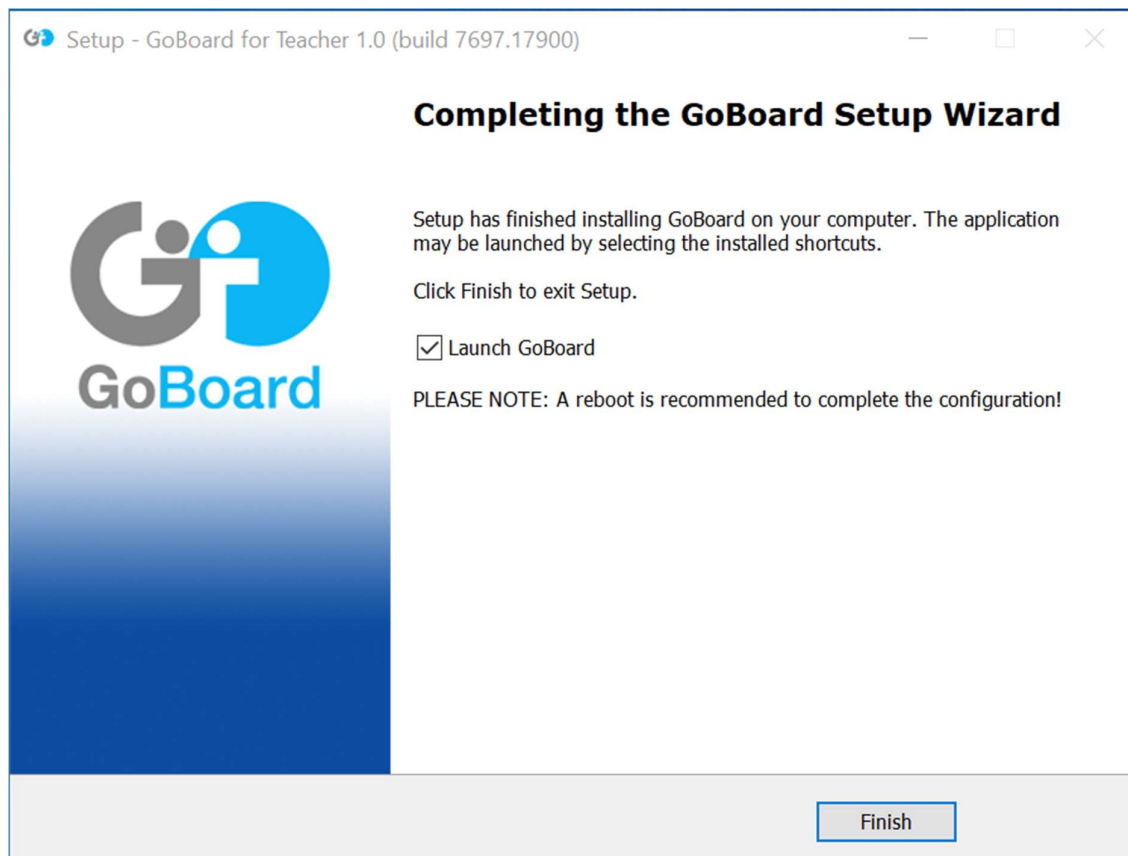

GoBoard setup wizard

The first time you open GoBoard software, the setup wizard will automatically start.

English is the default language; You can choose among:

1. English (United Kingdom)
2. English (United States)
3. Italian (Italy)
4. Spanish (Spain)
5. Portuguese (Portugal)
6. French (France)
7. French (Canada)
8. German (Germany)
9. Danish (Denmark)
10. Dutch (Netherlands)
11. Finnish (Finland)
12. Norwegian (Norway)
13. Swedish (Sweden).

Select your preferred language and then click on "Continue".

Welcome to GoBoard.
Please choose a language to start.

English (United Kingdom) ▼

Continue

There are three selectable installation modes. The default is HUB-only, but you may choose Teacher Console-only or Hub -Teacher Console combined. As mentioned previously, setting up the Hub on one PC and the Console on a separate PC allows greater mobility for the teacher who can move freely about the room with the console PC while the Hub PC remains connected to the display.

GoBoard Education software consists of 3 elements:

Main software “Hub”: for teaching environment - Hub software to be installed on static room PC or teachers laptop. As the name suggests, the "Hub" is the software that is primary heart of the software through a feature rich whiteboard, that allows connectivity to the companion apps required to make the most of GoBoard Education, and the wireless screen-sharing function.

The GoBoard Education Hub software is designed to be installed on either the teachers' laptop, or a PC that permanently resides in the learning environment (either must be Windows 10).

Teacher Console Software: for teacher – Content management software – To be installed on teachers' laptop. Designed to provide a convenient way for teachers to create and manage their content, the Teacher Console software is designed to be installed on the teachers' laptop.

Main functionality:

1. Creation of content by the teachers
2. Subject and lesson content indexing and management
3. Access to content wherever the teacher is (they don't have to be connected to a Hub to access and edit their lesson content)
4. Creation of quizzes & polls for use during lessons
5. Setting of teacher preferences.

Companion Apps: For students – To be installed on students mobile device connected to the same network as the software "Hub".

Allowing students to collaborate in learning sessions with the ability to view and edit the whiteboard (with teachers' permission).

Companion apps available for:

- iOS
- Android
- Chromebook
- Windows

Free to download.

NOTE: The companion app must be connected to the same network as the Hub.

How to install: 3 Options

Hub & Teacher Console software

There are **3 options when installing** GoBoard Education software, depending on the architecture of the school.

- Install the Hub on a static PC that permanently resides in the learn environment and then install the Teacher Console on the teachers' laptops.

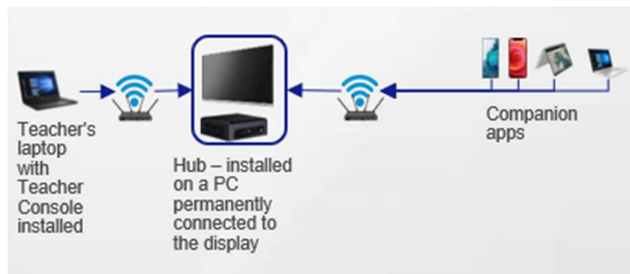

- Install the Hub software and Teacher Console software on teacher's own laptop.

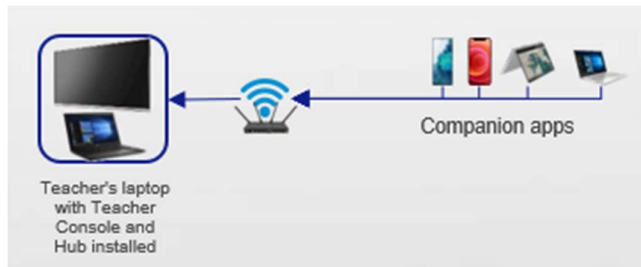

NOTE: In both cases (1 & 2), the teacher can access and work on their content wherever they are.

- If teachers' have no laptop, both Hub and Teacher Console software can be installed on a static PC that permanently resides in the learning environment.



NOTE: Options 1 and 2 are recommended, since option 3 means the teacher cannot work on their content when they are away from the Hub or working off-site.

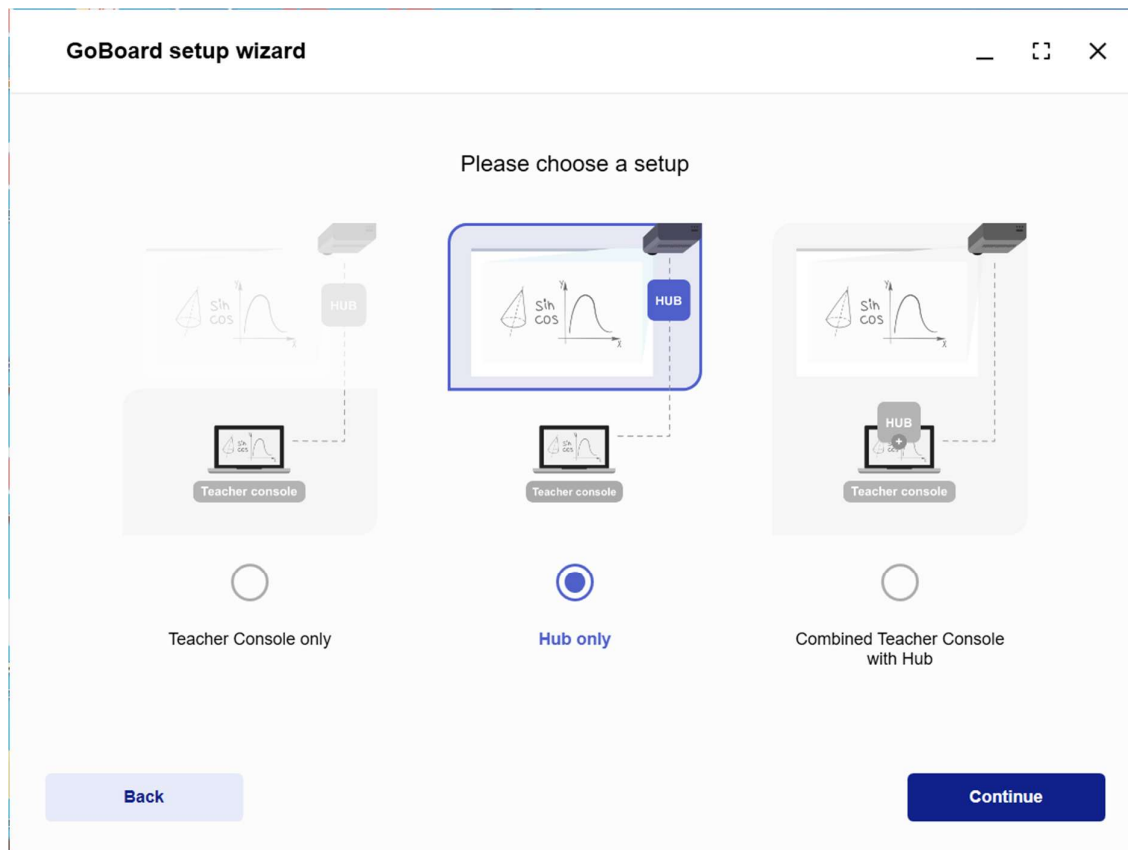

Hub Only allows the teacher to connect his/her own PC (the Console) to the Hub in order to share lessons created on his/her PC. Students can also connect their devices to the Hub via QR code reader or by manually entering the Hub's IP address and a code displayed on the whiteboard. There is also the option to start a stand-alone whiteboard session – blocking the connection of other devices - if that is desired.

Teacher Console Only. The Teacher Console is the workspace where teachers manage classes and prepare lessons. The teacher must then connect his/her device to the in-classroom hub via the Hub Only mode to share the lesson with students.

Combined Teacher Console with Hub enables the teacher to use his/her own device as the hub for sharing lessons with students. There is also the option to look for nearby hubs as with the Teacher Console Only mode.

Hub only configuration

How it works

The image below shows a typical Hub configuration.

The teacher and students can connect to the hub by scanning the hub QR code or by entering hub IP address manually.

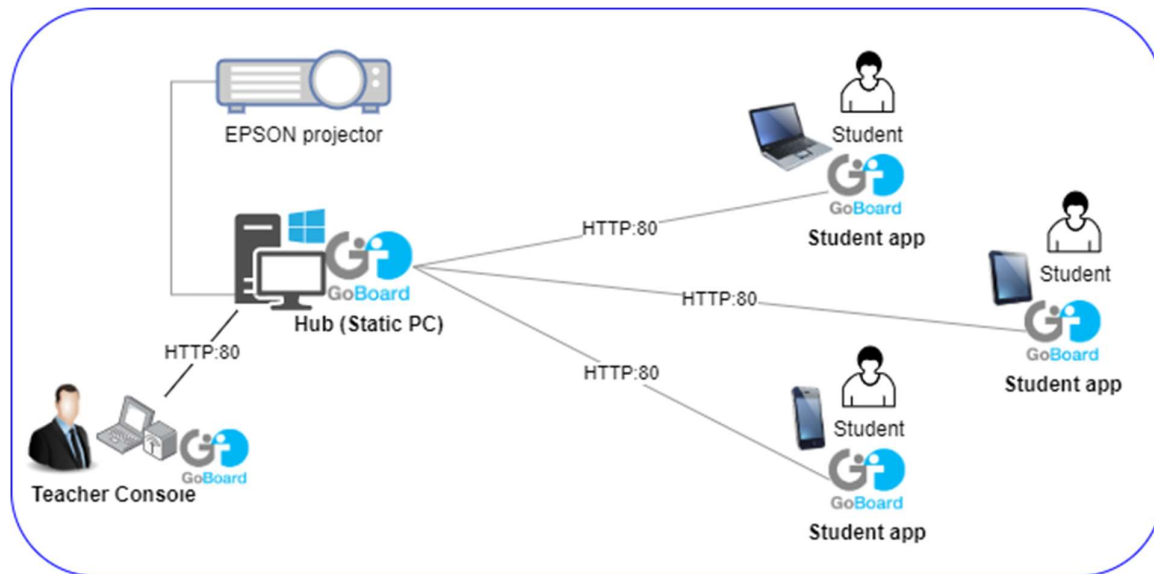

On GoBoard setup wizard of Hub only, a Classroom hub name must be decided upon and inserted, then click “Continue”.

For Example:

Classroom 6

Science lab

NOTE: It is recommended to use a strong name for the Hub. Avoid a generic name like “EPSON Projector”. It is recommended to use very specific names like “Classroom XYZ”. This will ensure that teachers launch the lesson to the correct Hub and not in a different classroom.

Please enter a classroom hub name

Classroom hub name

[Back](#) [Continue](#)

Enter a valid GoBoard Licence Key and then click on “Activate”. Licence keys can be found in the purchase confirmation email from GoBoard.

If you have yet to purchase a licence key, you can begin a free 30-day trial of GoBoard. At the end of 30-days, the software will become disabled.

A licence key can be purchased from an authorised Epson reseller.

NOTE:

Licence Keys and Management

With the purchase of each GoBoard licence, the user is entitled to install the Hub on one (1) computer, and the Teacher Console on as many as five (5) computers. If the Hub and Console are installed together onto a single computer, this would consume the Hub installation and one console. In this scenario, the user would have four (4) remaining Teacher Console seats which could be installed.

The Hub can be installed onto one (1) computer only. The licence for the Hub is not transferable to other computers. In the case that a user needs move an existing Hub licence from one computer to another, please contact Epson support.

Who is completing this form ?



End-customer



Channel partner / Reseller



Reseller confirms that:

(1) It has informed its customer upon whose behalf it is registering into this website that it will be providing to Epson personal data such as its customer's name(s), email address(es) of contact persons in customer's organisation.

(2) It has provided its customer with information on how Epson will use such personal data as shown in Privacy Information Statement [link]; and

(3) Reseller has procured its customer's consent to register and for Epson to process customer's personal data.



I consent to my personal data being held and used by Epson for marketing purposes, including conducting market analysis and surveys and to receive marketing communications about Epson products and services by post, e-mail, or other forms of electronic communications

Continue

NOTE: Make sure that the licence key is not expired, otherwise you will see this screen:

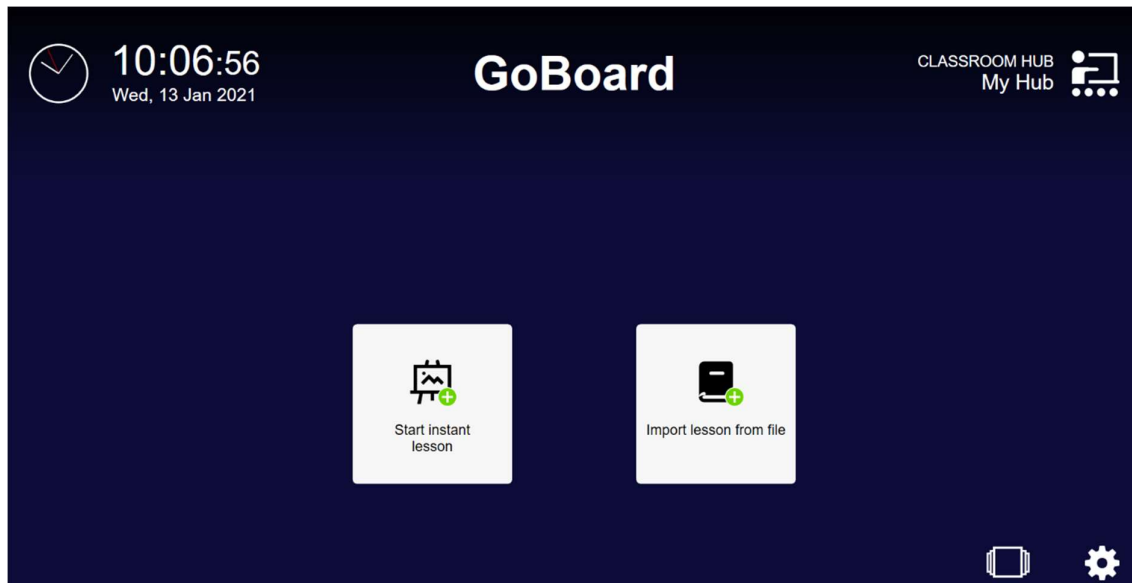

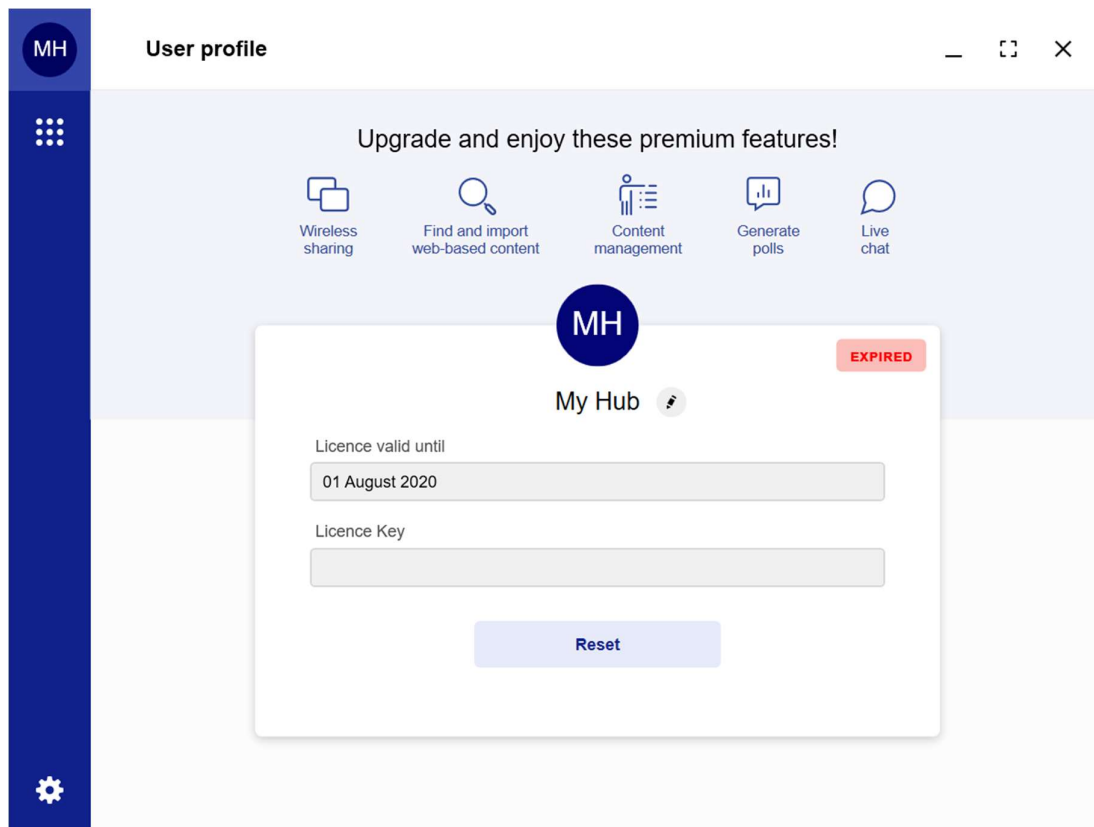

The GoBoard Hub-only mode has been successfully configured.

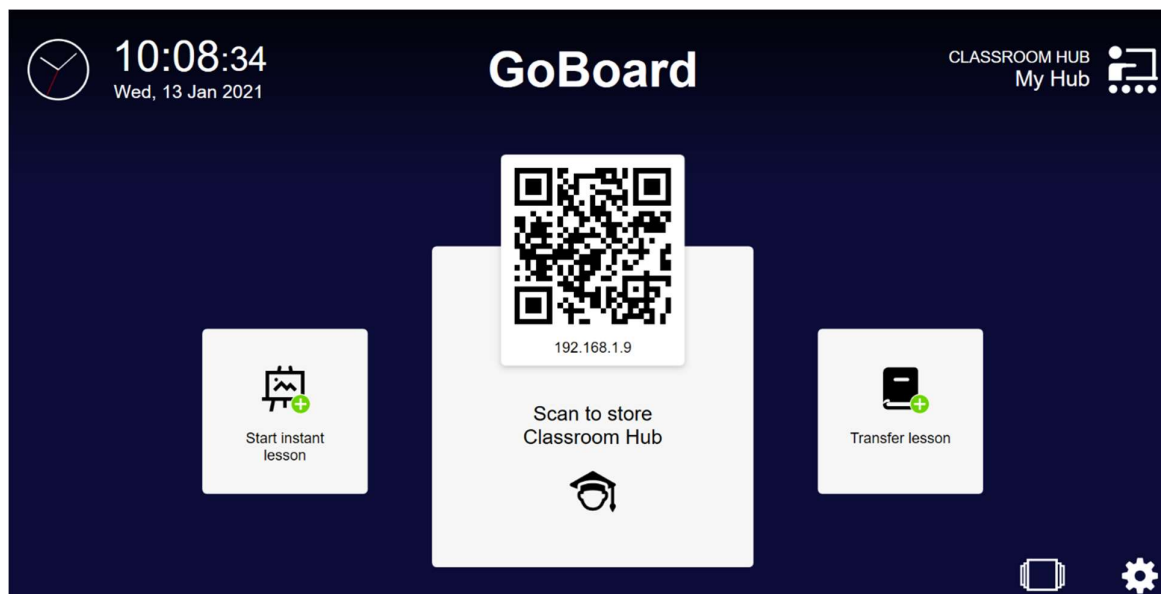

Installing Teacher Console only configuration

Please choose a setup

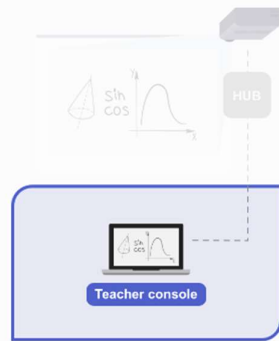

Teacher Console only

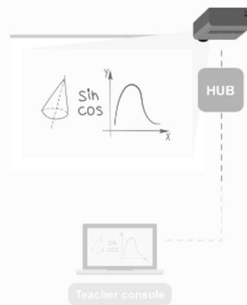

Hub only

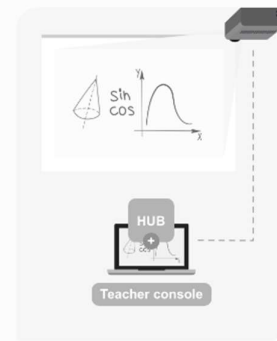
Combined Teacher Console
with Hub[Back](#)[Continue](#)

On GoBoard setup wizard for Teacher Console only, a first and last name must be inserted, then click "Continue".

Please enter your name



First name

Last name

Back

Continue

Enter a valid GoBoard Licence Key and then click on “Activate”. Licence keys can be purchased from an authorised Epson reseller – for more details go to Epson.eu/goboard (Western Europe).

If you have yet to purchase a licence key, you can begin a free 30-day trial of GoBoard. At the end of 30-days, the software will become disabled.

Please activate your copy of
GoBoard teacher console

Licence Key

Activate

Back

NOTE: Make sure that the licence key is not expired, otherwise you will see this message:

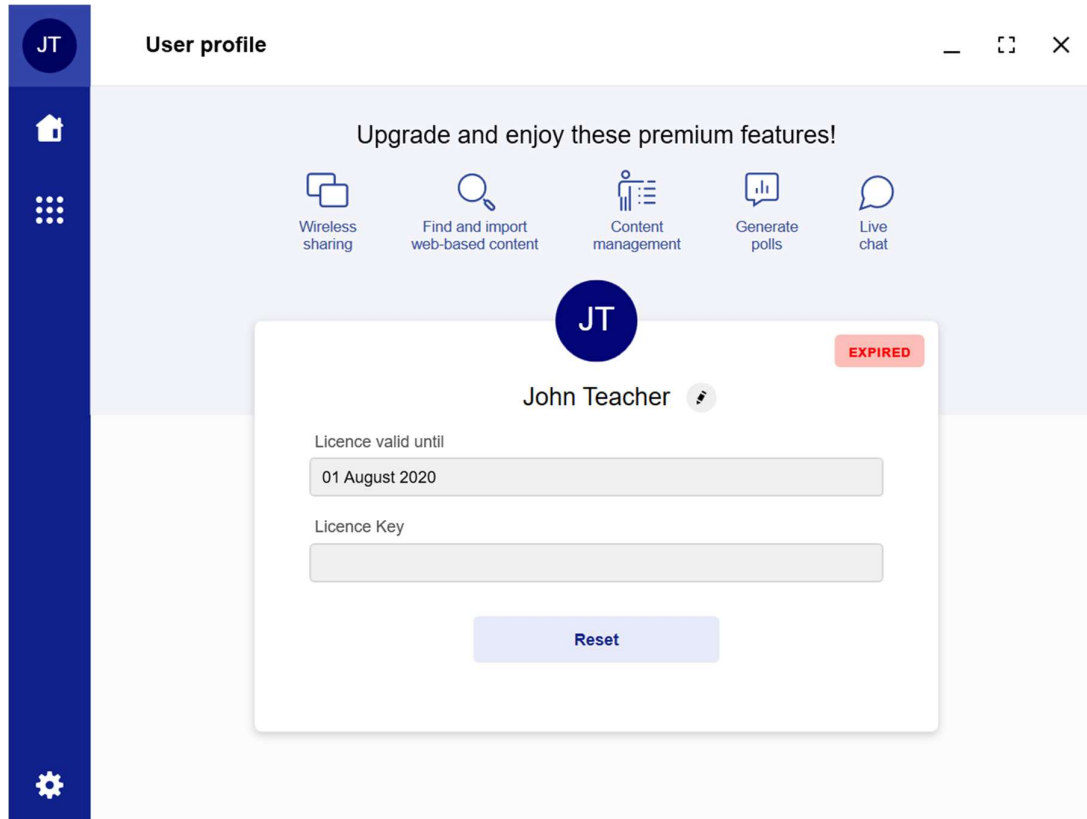
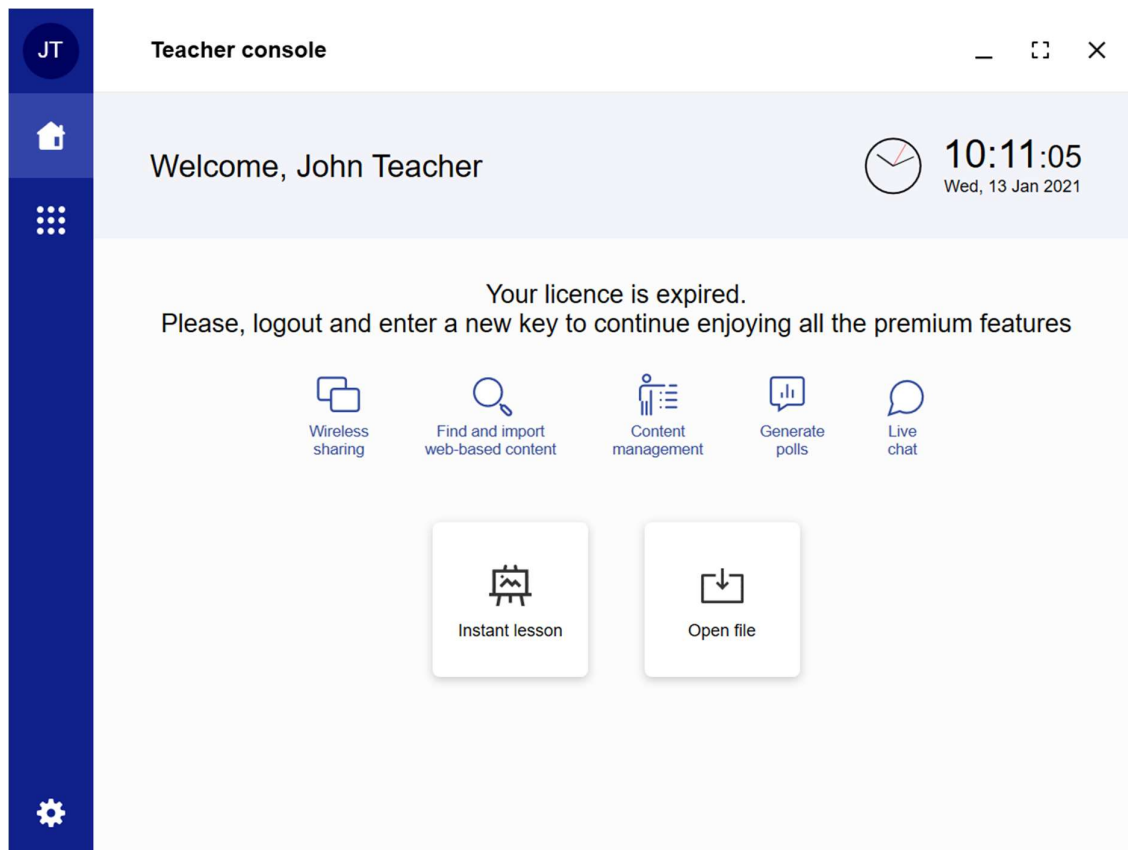

You can link a Google account for content backup purposes, otherwise to continue click on “Configure later”.

NOTE: Once you have linked a Google account, you will see your Google account name inside the ‘Backup account’ box located in the **Backup** menu in ‘Settings’.

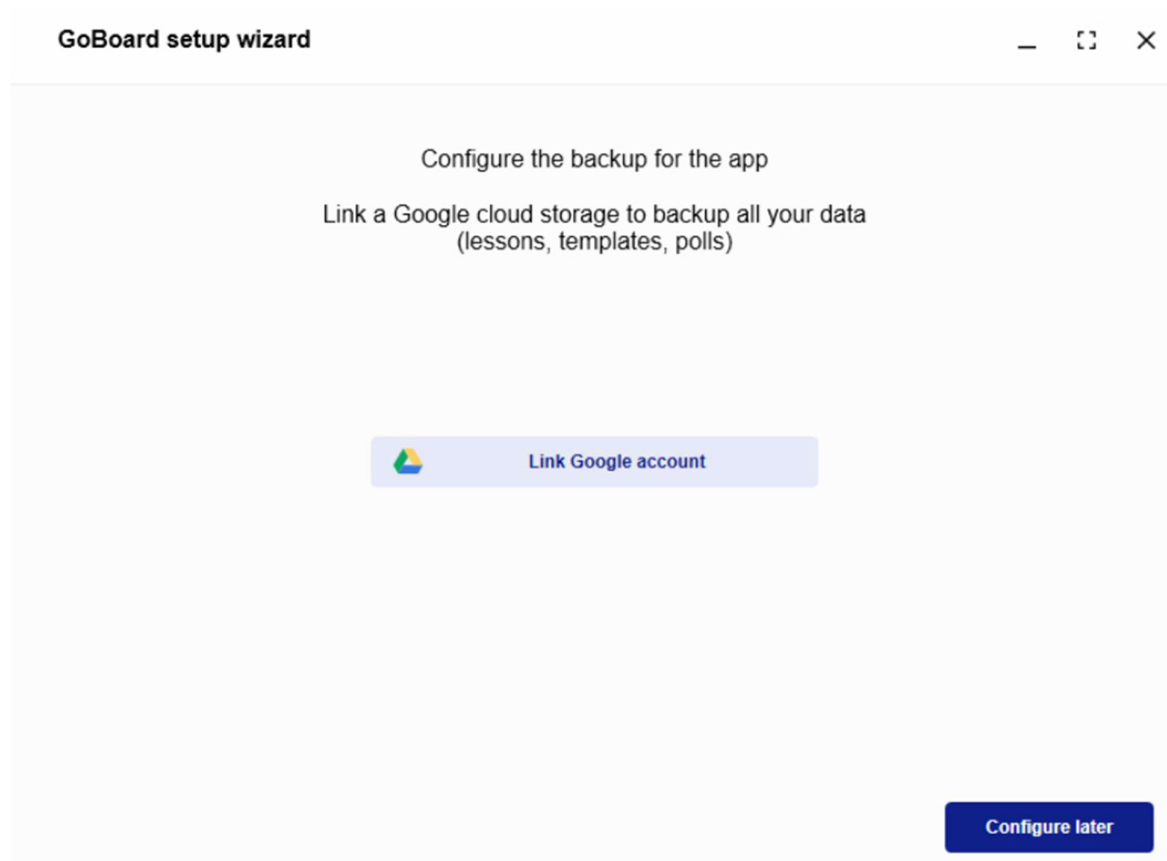

Now GoBoard Teacher Console has been successfully configured.

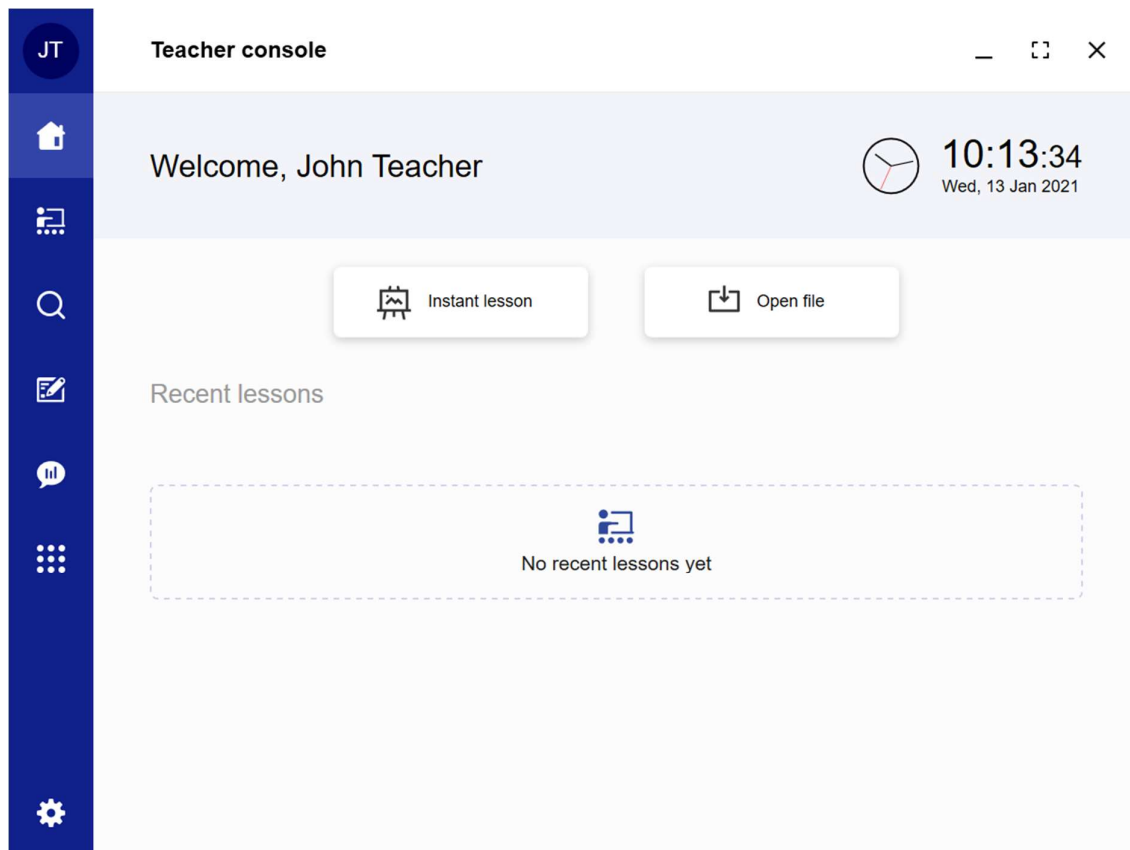

NOTE: To go from one mode to another (Teacher Console only, Hub only,

Combined Teacher Console with Hub), click your User profile  on the top left as seen in the image below.

Copy the licence key, then click “Reset”.

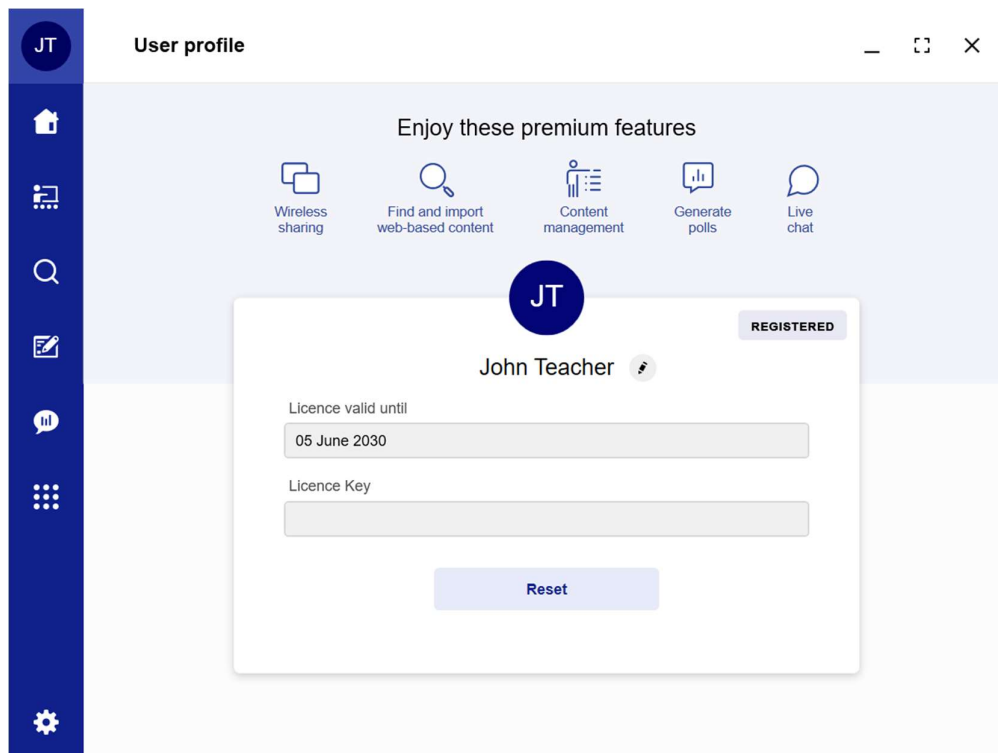

Click "Confirm".

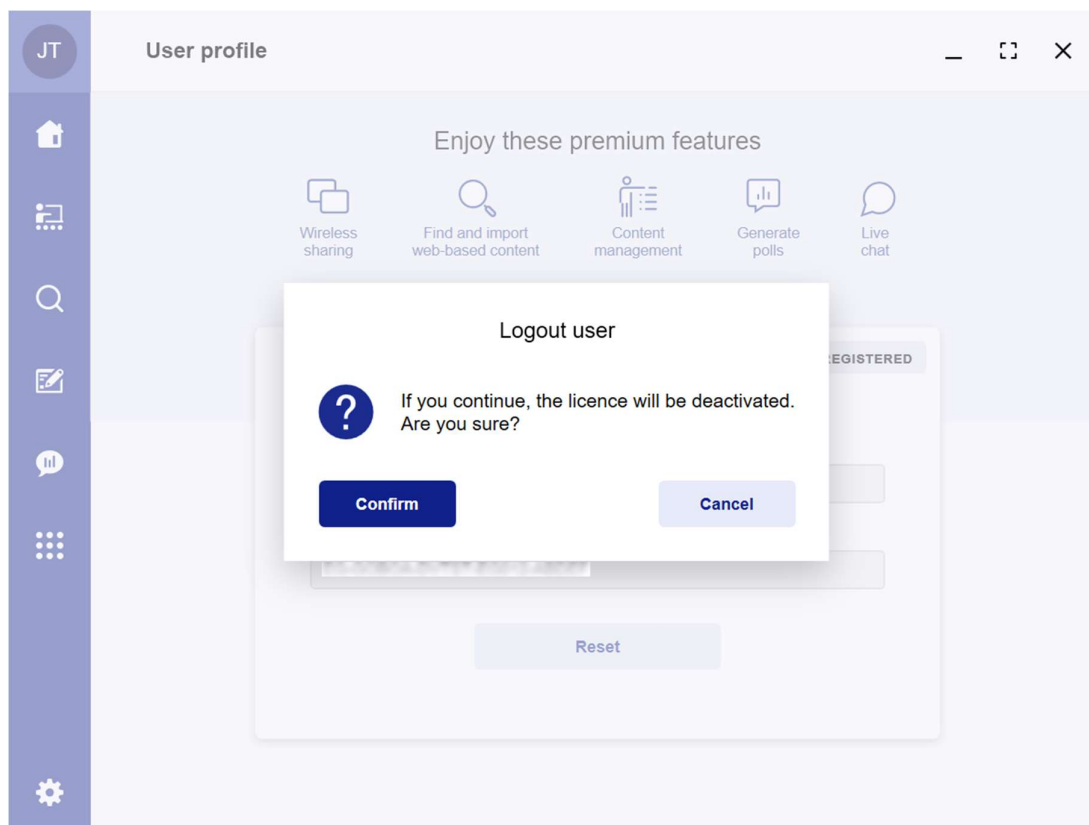

You will be returned to the GoBoard setup wizard.

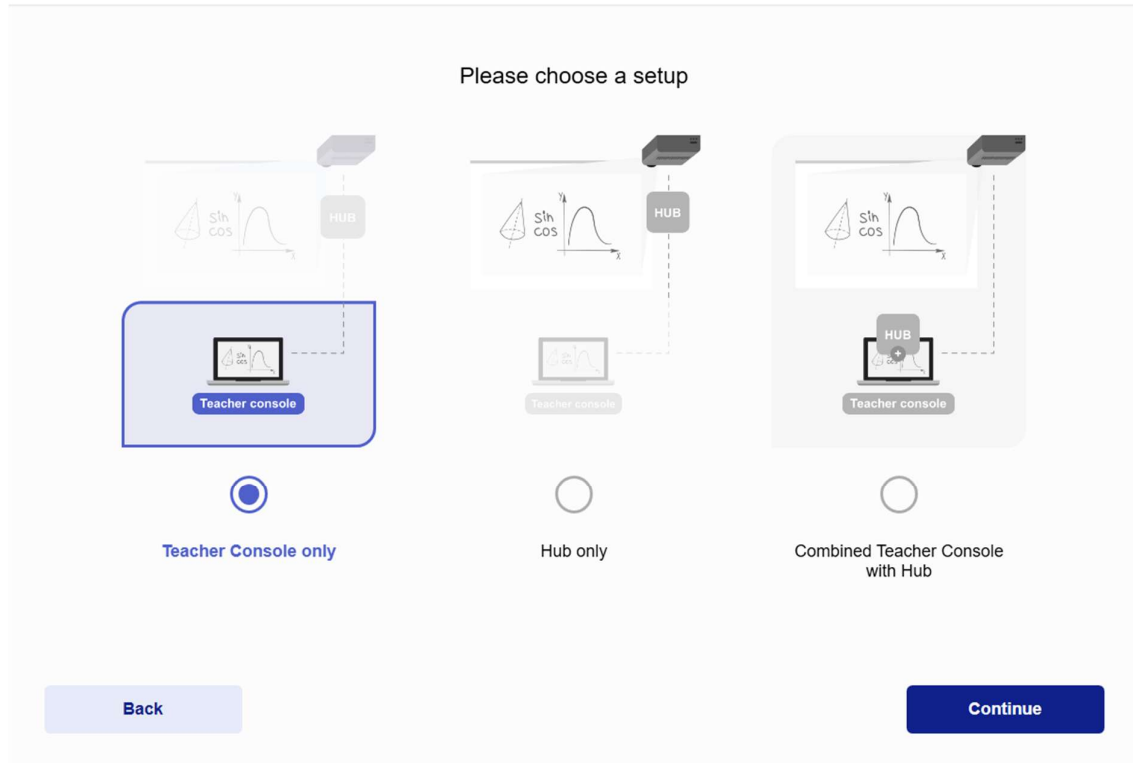

Installing Combined Hub/Teacher Console configuration

How it works

The image below shows a typical Combined Teacher Console with Hub configuration.

The teacher can use their own laptop as a hub device so students can connect to the hub by scanning the hub QR code or by entering the hub IP or address manually.

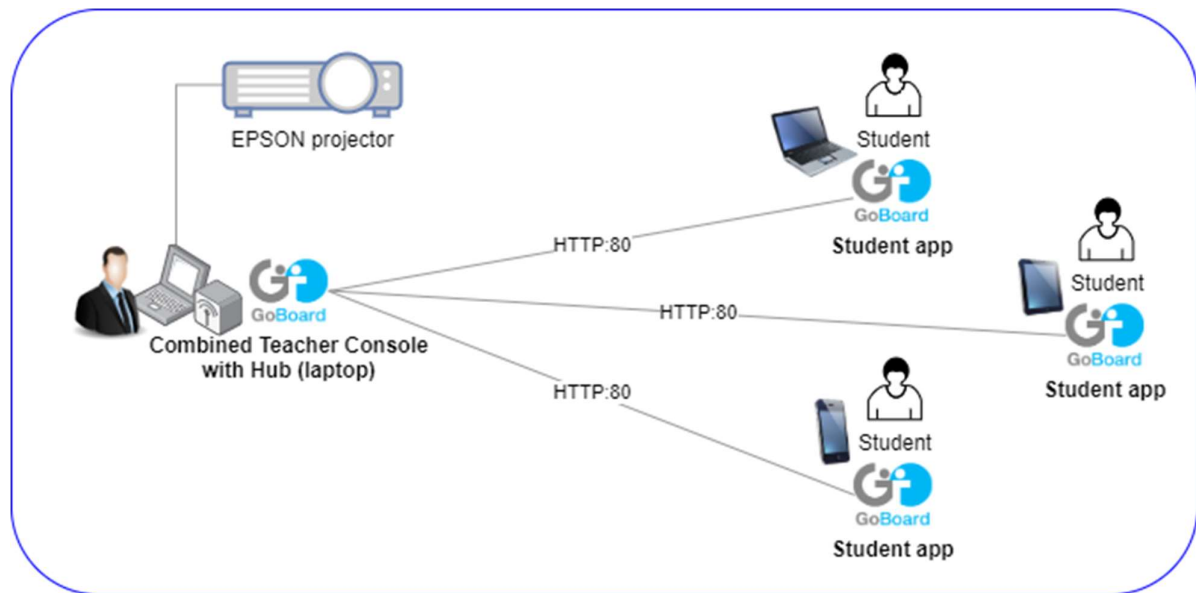

On the GoBoard setup wizard of Combined Teacher Console with Hub mode, a Teacher first and last name must be entered, then click "Continue".

GoBoard setup wizard — ⌵ ✕

Please enter your name



First name

Last name

 Please, note that your name will be used as Hub name

[Back](#) [Continue](#)

Enter a valid GoBoard Licence Key and then click on “Activate”. Licence keys can be found in the purchase confirmation email from GoBoard.

If you have yet to purchase a licence key, you can begin a free 30-day trial of GoBoard. At the end of 30-days, the software will become disabled.

A licence key can be purchased from an authorised Epson reseller.

NOTE:

Refer to page 14 to read the information about the **Licence Keys and Management**.

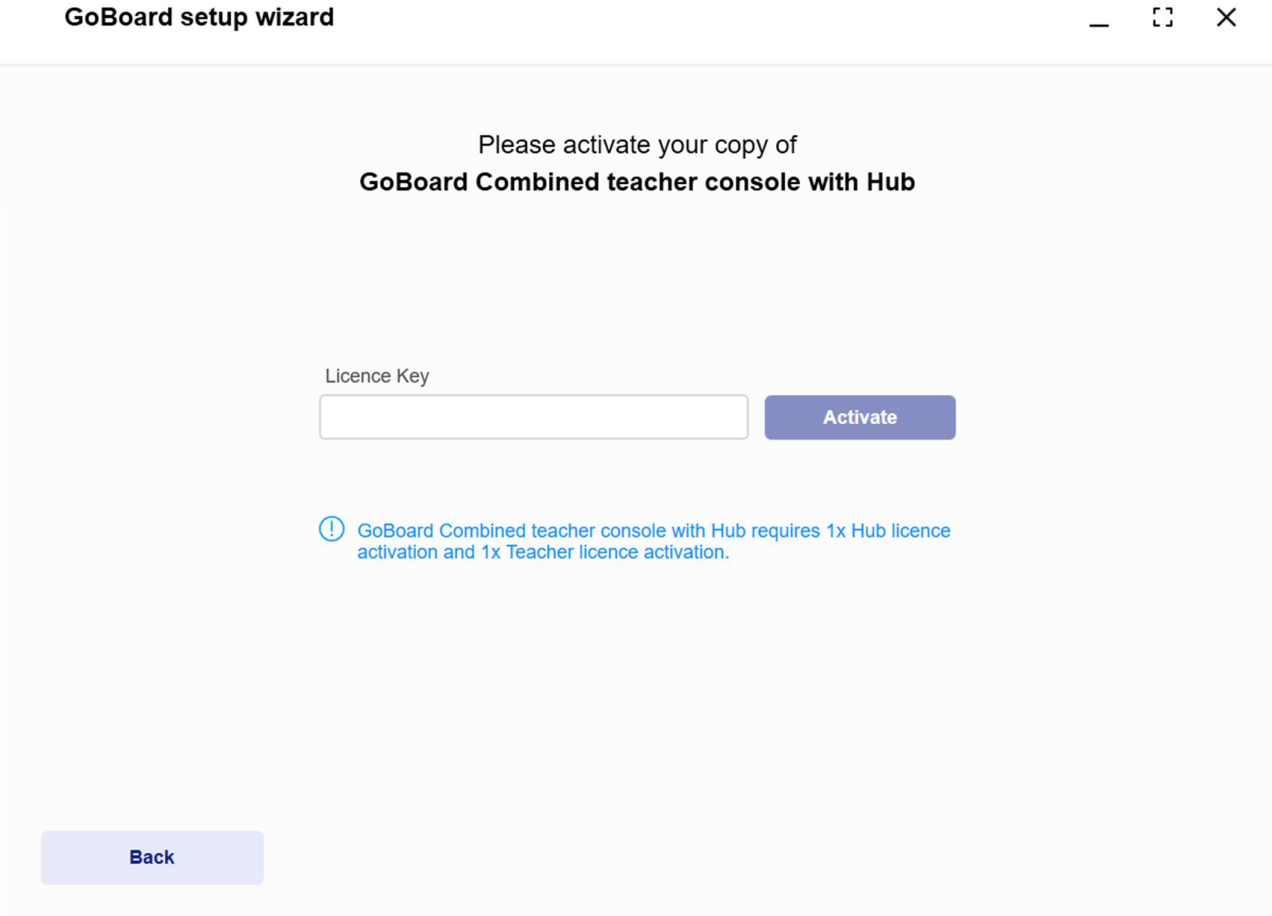

The image shows a window titled "GoBoard setup wizard" with standard window controls (minimize, maximize, close) in the top right corner. The main content area has a light gray background and contains the following elements:

- Text: "Please activate your copy of" followed by "GoBoard Combined teacher console with Hub" in bold.
- A label "Licence Key" above a text input field.
- A blue "Activate" button to the right of the input field.
- A blue warning icon (exclamation mark in a circle) followed by the text: "GoBoard Combined teacher console with Hub requires 1x Hub licence activation and 1x Teacher licence activation."
- A light blue "Back" button in the bottom left corner.

NOTE: Make sure that the licence key is not expired, otherwise you will see this message:

JT

Teacher console

—

⌵

×

🏠

⋮

⚙️

Welcome, John Teacher

🕒

10:16:20
Wed, 13 Jan 2021

Your licence is expired.
Please, logout and enter a new key to continue enjoying all the premium features

📄

Wireless sharing

🔍

Find and import web-based content

👤

Content management

📊

Generate polls

💬

Live chat

📺

Instant lesson

📄

Open file

JT

User profile

—

⌵

×

🏠

⋮

⚙️

Upgrade and enjoy these premium features!

📄

Wireless sharing

🔍

Find and import web-based content

👤

Content management

📊

Generate polls

💬

Live chat

JT

John Teacher

✎

EXPIRED

Licence valid until

01 August 2020

Licence Key

Reset

You can link a Google account for backup purposes, otherwise to continue click on “Configure later” button.

NOTE: once you have linked a Google account, you will see your Google account name inside the ‘Backup account’ box located in the **Backup** menu in ‘Settings’.

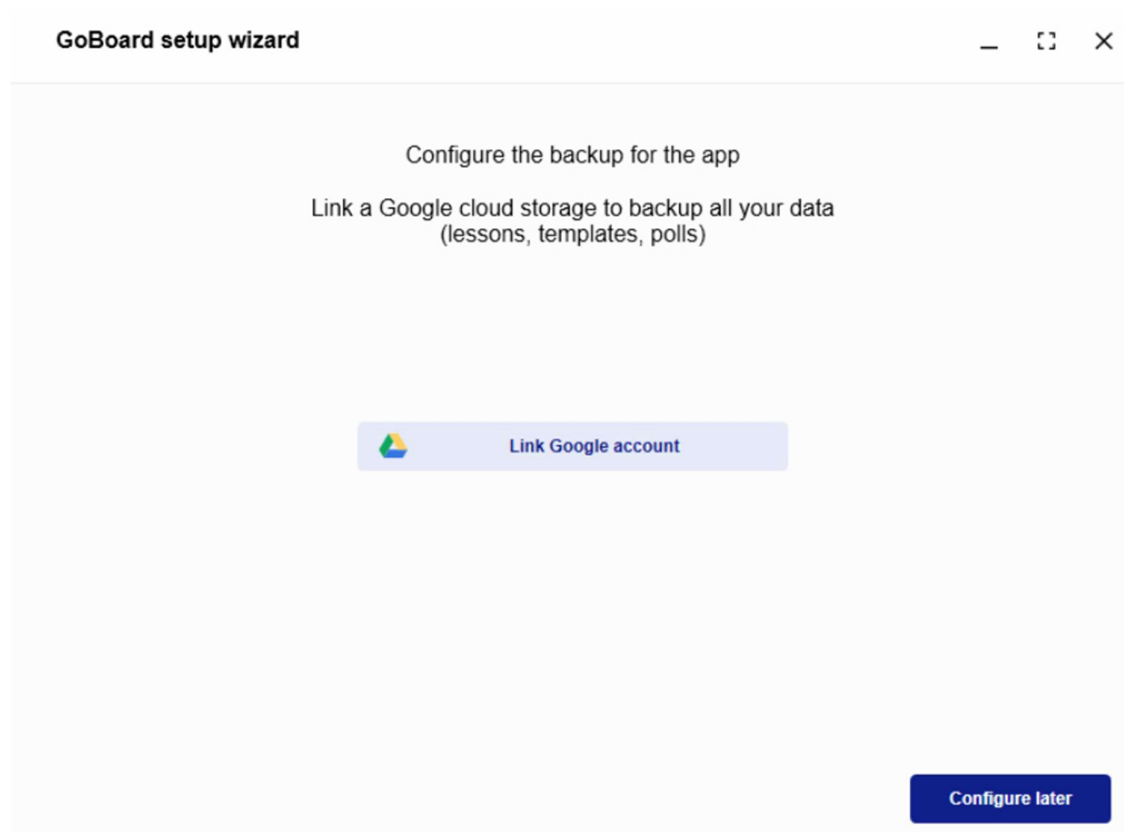

Now GoBoard Combined Teacher Console with Hub mode has been successfully configured.

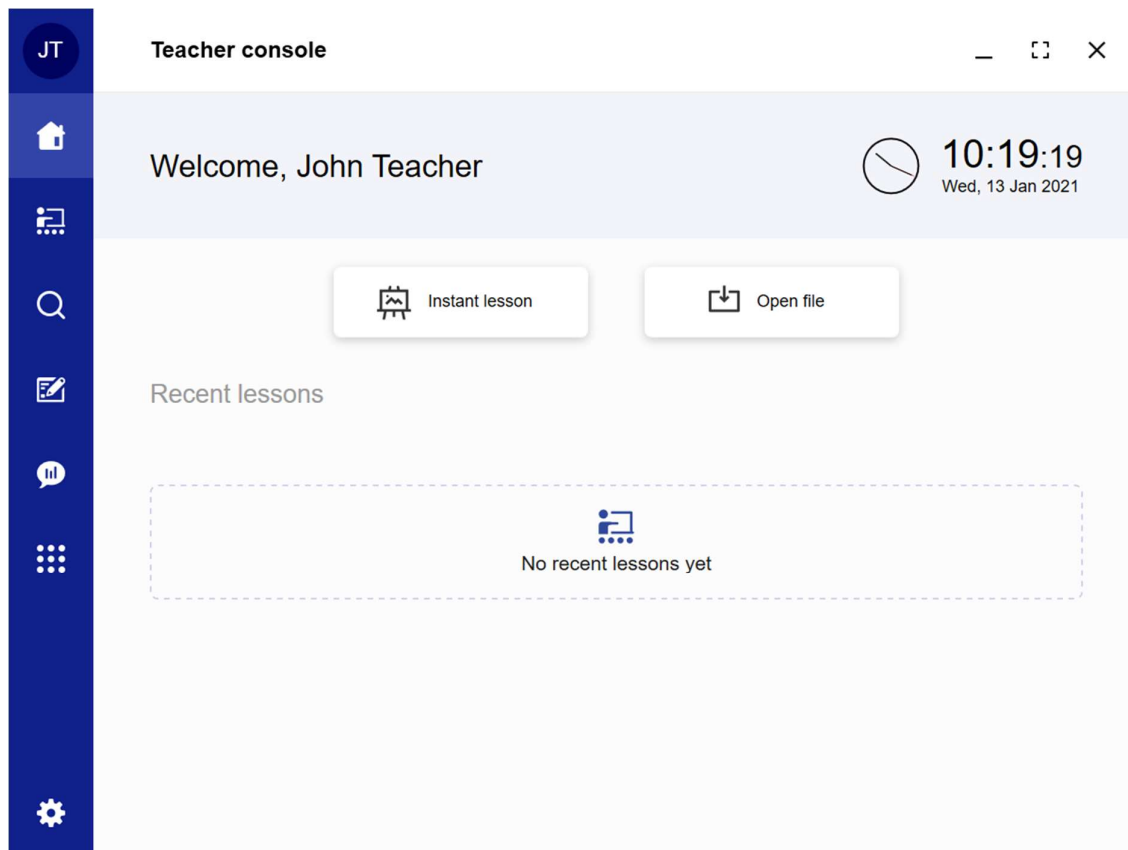

GoBoard Student Apps

Other devices including PCs, Android Chromebooks, Android, iOS and Windows devices can connect to a whiteboard session as viewer and/or contributors. In order to do so, you must first download the free GoBoard apps from the associated app stores.

Participants can download the app from App Store or Google play by searching for "GoBoard".



Link and QR code: <https://apps.apple.com/app/goboard/id1529617339>



Link and QR code:

<https://play.google.com/store/apps/details?id=com.remago.goboard>



Link and QR code: (Windows Student app)

Software distribution - Export

If you already have GoBoard installed on your device, you will need to go to the Settings menu to Export any editable settings as you will need to uninstall GoBoard and reinstall it again to be able to have your chosen settings saved and as default. This is a job that is done by an IT manager to do mass installations.

You will then automatically see the mode you have chosen to utilise, and you will **no longer need to enter licence key details** as they will automatically have been entered by the system.

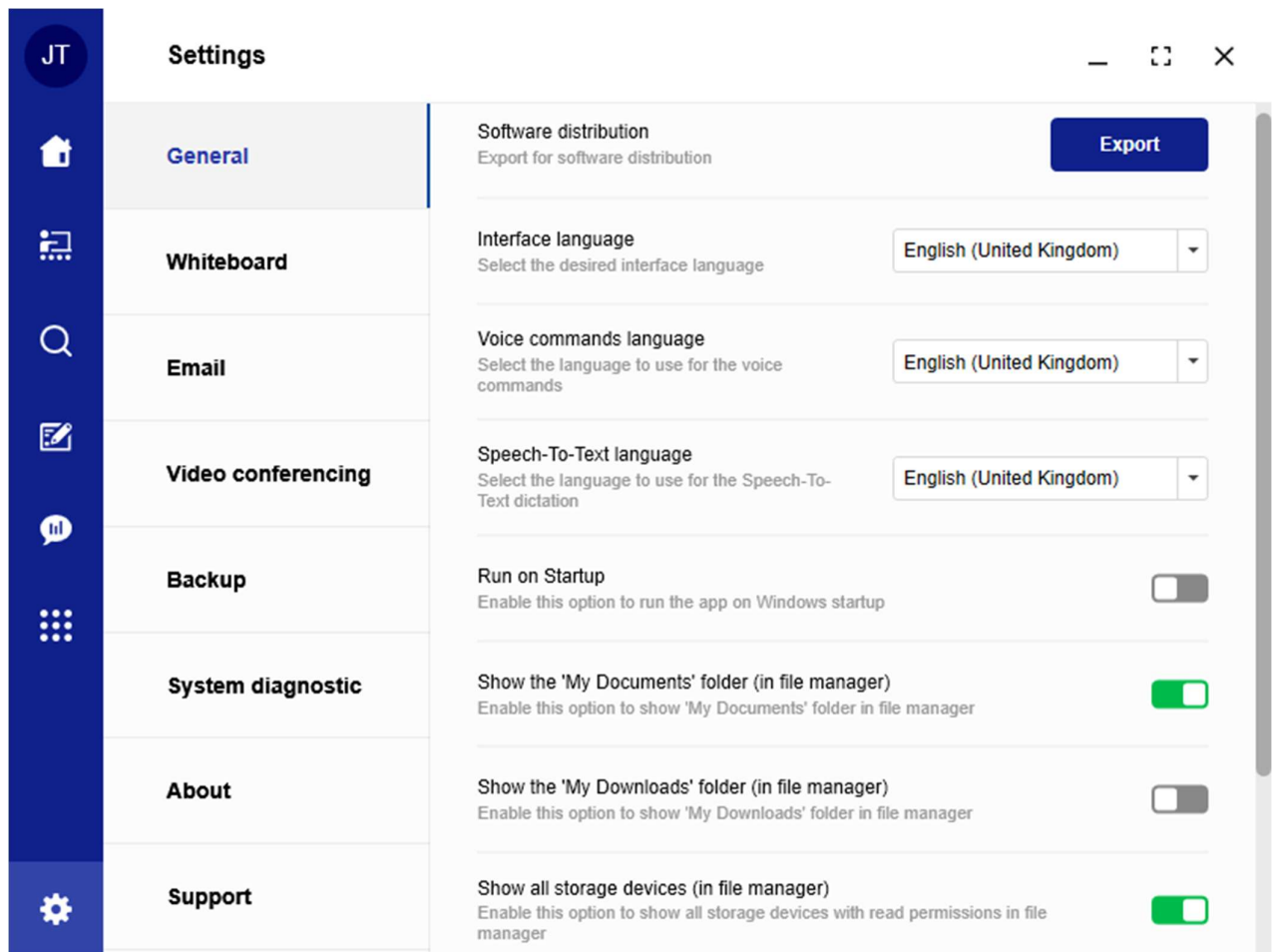

Click the “**Export**” button to export for software distribution.

Settings that you can export are:

1. Your choice of language
2. Installed mode (Teacher console, Hub or Combined Teacher Console with Hub)
3. Licence key serial number
4. “Run on Startup” flag
5. “Kiosk Mode” flag (only visible in Hub mode)
6. Settings password (only visible in Hub mode)
7. “Extend to multiple displays” flag for double display (only visible if you have two connected displays)

To import the settings onto another machine, once the file has been exported, transfer it to another computer via a USB key, from this other computer copy the file and paste it inside the “Desktop” folder. Please make sure that also the setup is in the same folder, when the file and the setup are in the same folder start the installation.

Teacher Console and Combined Teacher Console with Hub settings

Select the **language** and activate **Run on Startup**. Click on the blue “Export” button for Software distribution. You will be asked where to save the exported file. Select the preferred folder and then uninstall GoBoard for Teachers.

Reinstall GoBoard for Teachers and make sure that the installation setup is in the same folder of the exported file. You will notice that exported settings will be automatically imported, and you will not be asked to input the licence key as it has been automatically inserted. The teacher will now see his/her device name as his/her profile.

Teacher Console

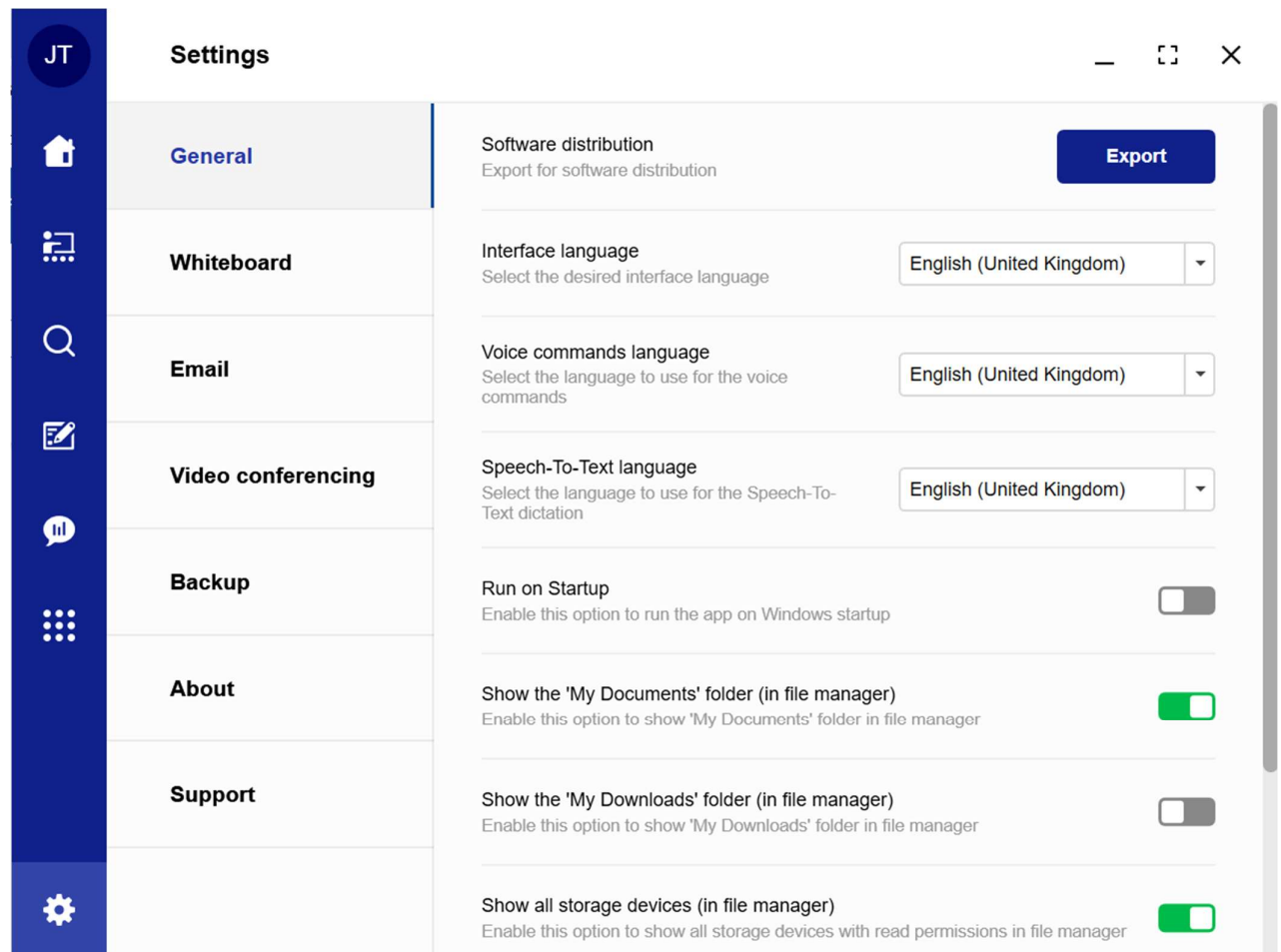

Combined Teacher Console with Hub

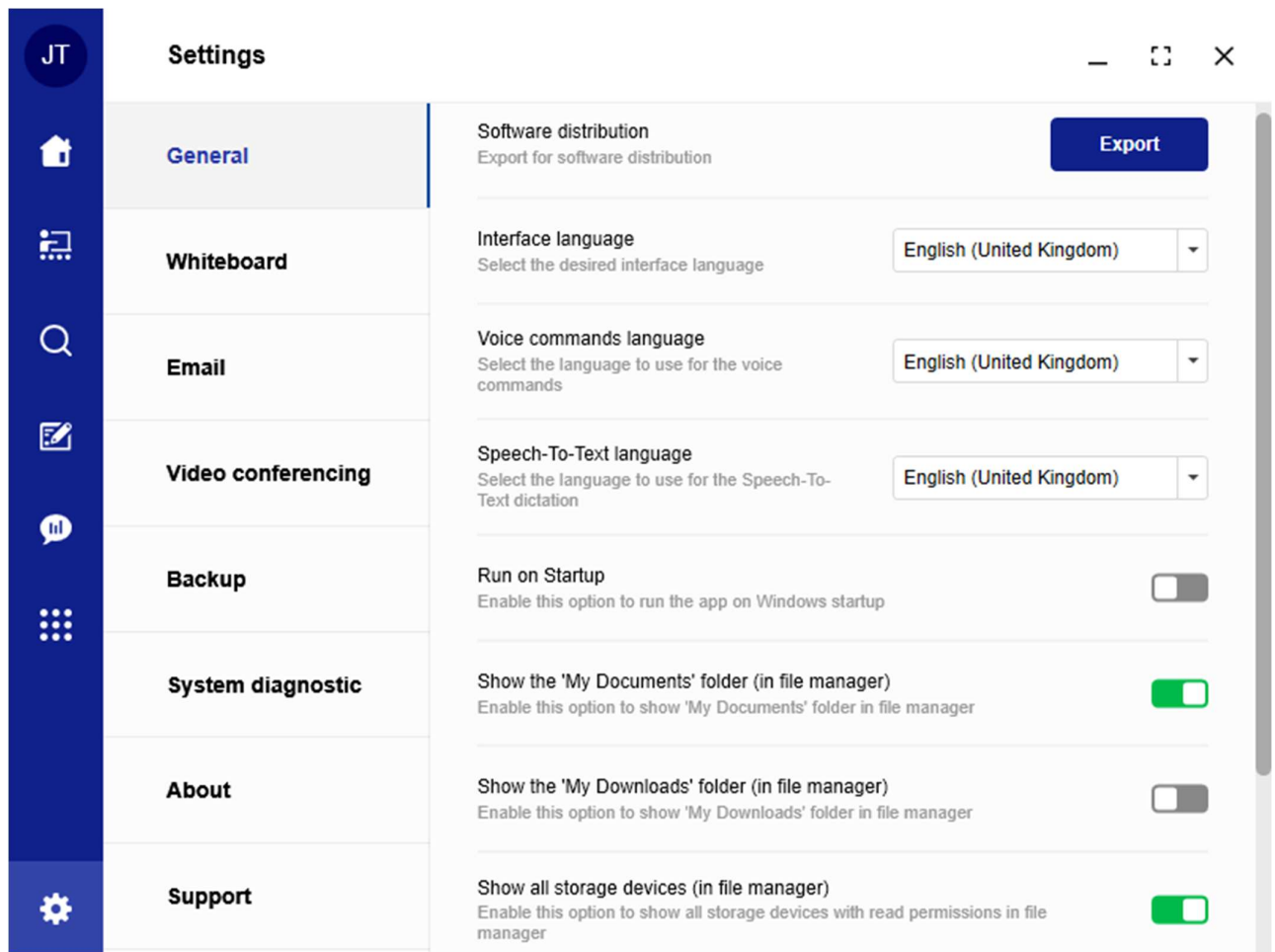

NOTE: The “**Extend to multiple displays**” flag will only be visible if the two display resolutions are identical, the two DPI are identical, the primary monitor is on the left and the secondary monitor is on the right.

When you have two connected displays, the “Record all displays” flag will also be visible as you can see on the image below.

NOTE: Close and reopen GoBoard to view the settings changes.

Teacher Console

JT

Home

Whiteboard

Search

Tools

Chat

Apps

Settings

Settings

General

Whiteboard

Email

Video conferencing

Backup

About

Support

Software distribution

Export for software distribution

Export

Interface language

Select the desired interface language

English (United Kingdom)

Voice commands language

Select the language to use for the voice commands

English (United Kingdom)

Speech-To-Text language

Select the language to use for the Speech-To-Text dictation

English (United Kingdom)

Run on Startup

Enable this option to run the app on Windows startup

Extend to multiple displays

Enable this option to extend the app to the next display

Record all displays

Enable this option to record all available displays

Show the 'My Documents' folder (in file manager)

Enable this option to show 'My Documents' folder in file manager

Combined Teacher Console with Hub

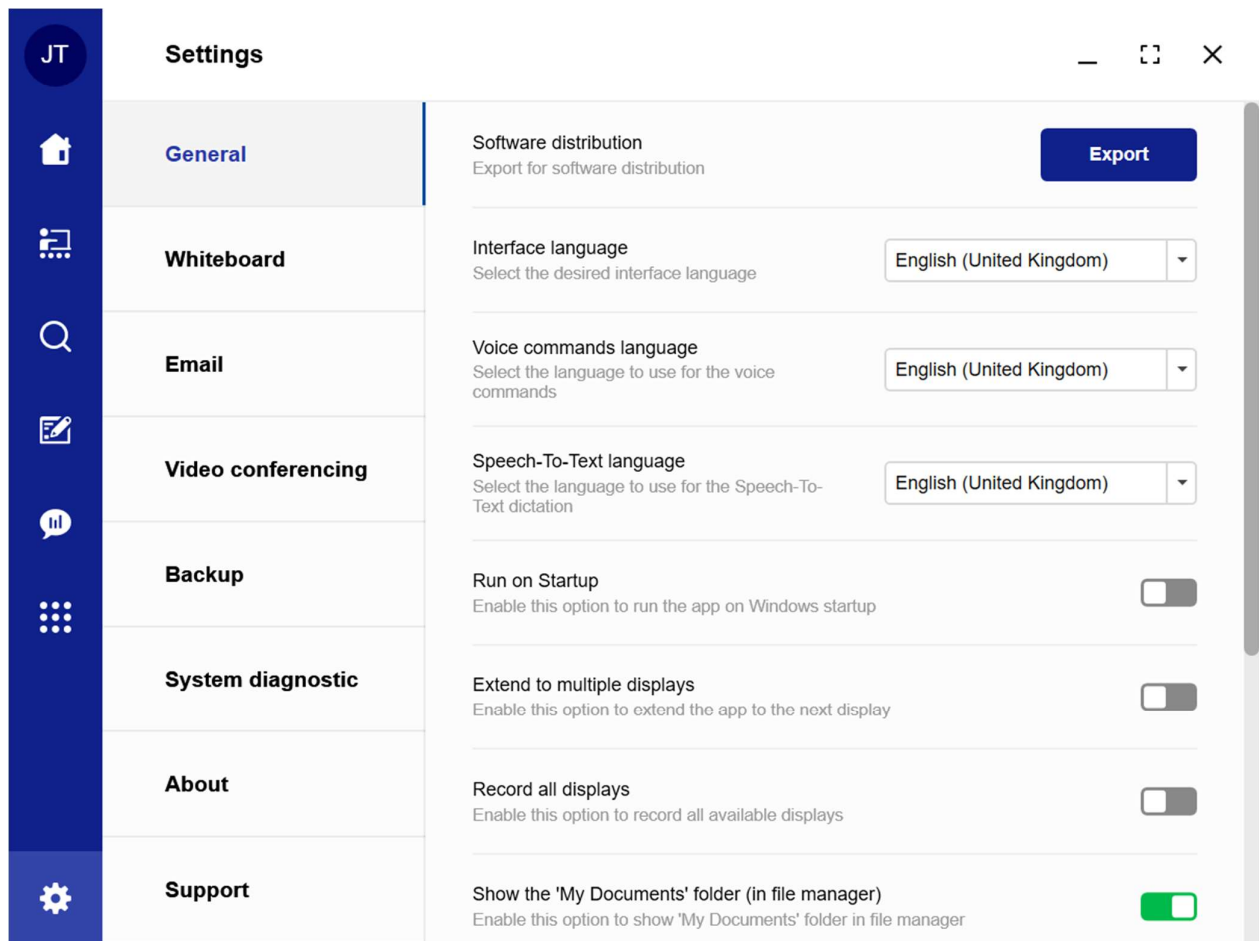

Hub settings

You can select the **language**, activate **Kiosk Mode**, insert a **password** to access the settings window and activate **Run on Startup**. Kiosk Mode prevents user interaction and activities on the device outside the scope of execution of the software. Click on the blue “Export” button for Software distribution. You will be asked where to save the exported file. Select the preferred folder and then uninstall GoBoard for Teachers.

Reinstall GoBoard for Teachers and make sure that the installation setup is in the same folder of the exported file. You will notice that exported settings will be automatically imported, and you will not be asked to input the licence key as it has been automatically inserted. The teacher will now see his/her device name as his/her profile.

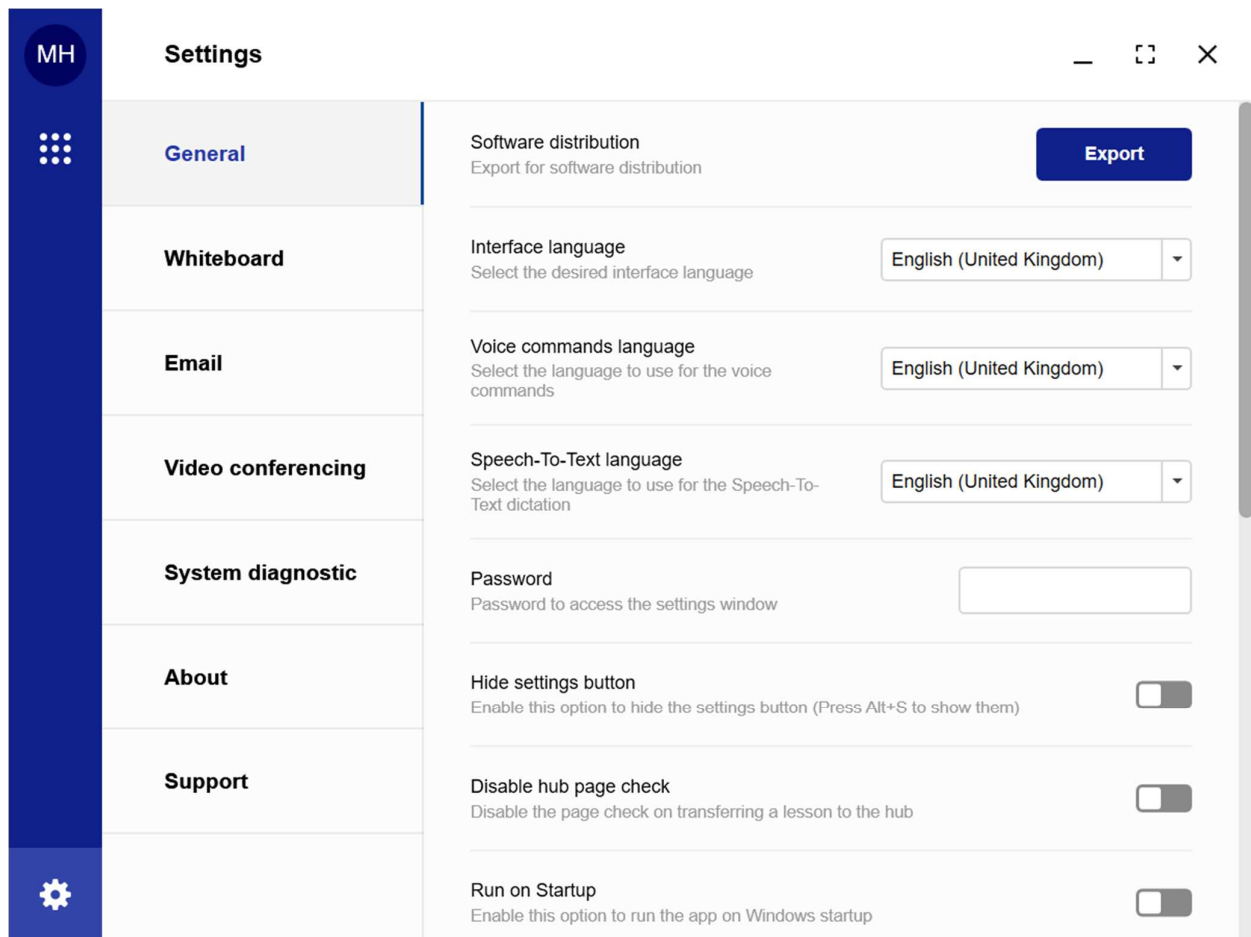

NOTE: The “**Extend to multiple displays**” flag will only be visible if the two display resolutions are identical, the two DPI are identical, the primary monitor is on the left and the secondary monitor is on the right.

When you have two connected displays, the “Record all displays” flag will also be visible as you can see on the image below.

NOTE: Close and reopen GoBoard to view the settings changes.

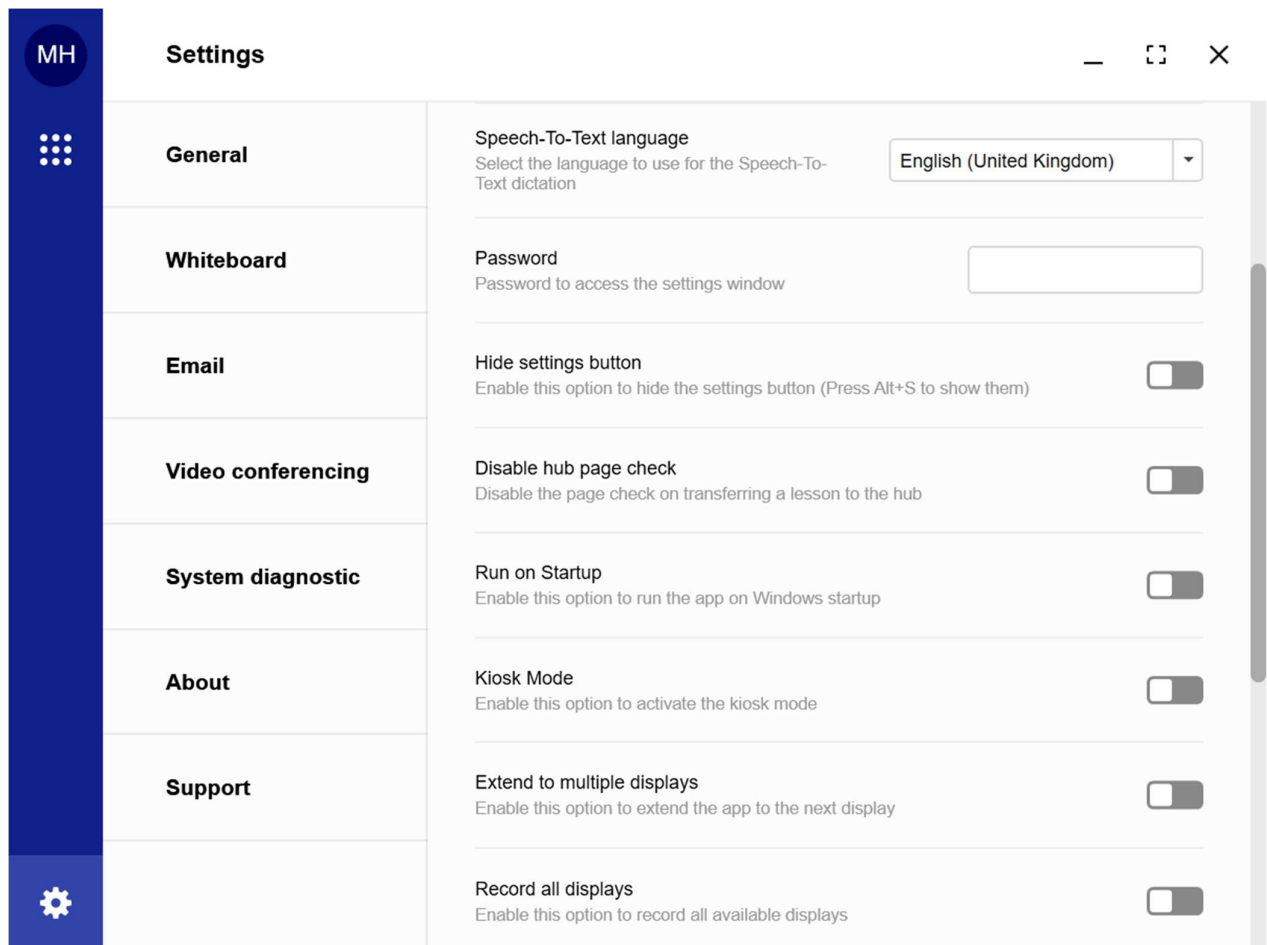

Requirements

Windows 10 Hub

Minimum Requirements

- Windows 10 version 1803
- CPU quad-core 2 GHz
- RAM DDR3 8 GB
- Cam and microphone (for AV conferences)

Optimal Specs

- Dedicated graphics card (recommended)

Windows 10 Teacher Console

Minimum Requirements

- Windows 10 version 1803
- CPU quad-core 2 GHz
- RAM DDR3 8 GB
- Cam and microphone (for AV conferences)

Optimal Specs

- Dedicated graphics card (recommended)
- Stylus (for best handwriting/drawing experience)

GoBoard Preferred network ports used for Wireless communication

Whiteboard:

8033 port TCP protocol

Hub discovery:

8035/8036 UDP

AirServer:

Port	Used by	Behaviour/Notes
TCP 80, 443, 8008, 8009	Google Cast	
UDP 53, 123, 1900	Google Cast	
Port	Used by	Behaviour/Notes
TCP 5000	AirPlay RAOP	Will use a dynamic port if unavailable
TCP 5001	AirPlay RAOP events	Will use a dynamic port if unavailable
TCP 7000	AirPlay media	Will use a dynamic port if unavailable
TCP 7100	AirPlay legacy mirroring	Fixed port - cannot be changed. Only needed to support iOS 6 & older
TCP 49152	AirPlay mirroring	Will use a dynamic port if unavailable
UDP 6010-6012	AirPlay audio	Will use AirPlayAudioUDPPort, AirPlayAudioUDPPort+1 & AirPlayAudioUDPPort+2
UDP 5353	Apple Bonjour	

Port	Used by	Behaviour/Notes
UDP 51563	Miracast	Will use a dynamic port if unavailable (configured on local firewall only)
UDP and TCP 7236	Miracast	Ports used for negotiation
TCP 7250	Miracast	RMTP port for video streaming
UDP and TCP 50000	Miracast	Ports used for negotiation

Where To Get Help

If you need to contact Epson for technical support services, visit Epson's support website at epson.eu/contact-us and select your country.

© 2021